



CoreLine Wall-mounted

WL120V LED12S/830 PSU GR

LED Module, system flux 1200 lm – 830 warm white – Power supply unit – Gray

CoreLine Wall-mounted is a circular-shaped surface-mounted luminaire that is easy to apply in circulation areas such as hallways and staircases. The modern unobtrusive design, in combination with its homogeneous light distribution it delivers, ensures that this luminaire blends into most building architectures. With the push-in connectors, installation is fast and straightforward.

Product data

General Information		Flammability mark	For mounting on normally flammable surfaces
Number of light sources	1 pc	CE mark	CE mark
Lamp family code	LED12S [LED Module, system flux 1200 lm]	ENEC mark	-
Beam angle of light source	120 °	Warranty period	3 years + 2 years upon registration
Light source color	830 warm white	Remarks	*-Per Lighting Europe guidance paper "Evaluating performance of LED based luminaires - January 2018": statistically there is no relevant difference in lumen maintenance between B50 and for example B10. Therefore the median useful life (B50) value also represents the B10 value.
Light source replaceable	No	Constant light output	No
Number of gear units	1 unit	Number of products on MCB of 16 A type B	15
Driver/power unit/transformer	Power supply unit	RoHS mark	RoHS mark
Driver included	Yes		
Optic type	Symmetrical		
Luminaire light beam spread	180°		
Emergency lighting	-		
Connection	Push-in connector and pull relief		
Cable	-		
Protection class IEC	Safety class I		
Glow-wire test	Temperature 850 °C, duration 30 s		

CoreLine Wall-mounted

Operating and Electrical

Input Voltage	220 to 240 V
Input Frequency	50 to 60 Hz
Inrush current	22 A
Inrush time	0.32 ms
Power Factor (Min)	0.9

Controls and Dimming

Dimmable	No
----------	----

Mechanical and Housing

Housing Material	Composite materials
Reflector material	-
Optic material	Polycarbonate
Optical cover/lens material	Polycarbonate
Fixation material	Polyamide
Optical cover/lens finish	Opal
Overall height	120 mm
Overall diameter	344 mm
Height	120 mm
Color	Gray

Approval and Application

Ingress protection code	IP65 [Dust penetration-protected, jet-proof]
Mech. impact protection code	IK10 [20 J vandal-resistant]

Initial Performance (IEC Compliant)

Initial luminous flux (system flux)	1200 lm
-------------------------------------	---------

Luminous flux tolerance	+/-10%
Initial LED luminaire efficacy	67 lm/W
Init. Corr. Color Temperature	3000 K
Init. Color Rendering Index	>80
Initial chromaticity	(0.47, 0.42) SDCM<3
Initial input power	18 W
Power consumption tolerance	+/-10%

Application Conditions

Ambient temperature range	-20 to +35 °C
Performance ambient temperature Tq	25 °C
Suitable for random switching	No

Product Data

Full product code	871869606642399
Order product name	WL120V LED12S/830 PSU GR
EAN/UPC - Product	8718696066423
Order code	910503910019
Numerator - Quantity Per Pack	1
Numerator - Packs per outer box	6
Material Nr. (12NC)	910503910019
Net Weight (Piece)	1.650 kg

Dimensional drawing

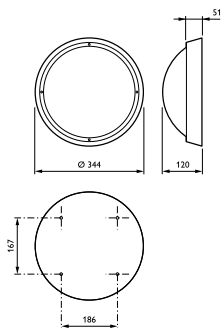

CoreLine Wall-mounted WL120V/WL121V

CoreLine Wall-mounted

